

**UKMEDICAL®**

*It's Interventional.*

# *It's the Ella Extractor/*

*For atraumatic  
stent removal /*

*hello@ukmedical.com  
ukmedical.com*



# *It's about atraumatic stent removal... /*

*The Ella Extractor provides safe, atraumatic removal of Ella nitinol oesophageal stents using a combined endoscopic and fluoroscopic technique.*

*Designed to resheath a stent with minimal lateral movement, the Ella Extractor reduces the risk of damage to oesophageal mucosa.*

*Particularly suited to removal of the Danis stent for cases with a higher risk of variceal re-bleed, the extractor provides you with peace of mind and enables faster patient recovery.*

## **Product benefits:**

- ***Safe, atraumatic stent removal of Ella nitinol stents***
- ***Reduces risk of variceal re-bleed & reintervention***
- ***Minimises risk of complications associated with stent removal***
- ***Faster patient recovery following stent removal***
- ***Versatile oesophageal stent removal***
- ***Effective removal of migrated stents***

## **Additional information?**

If you would like further assistance with using our Ella Extractor, or need advice on how to order, please call us on: **0114 268 8880**



**Product features:**

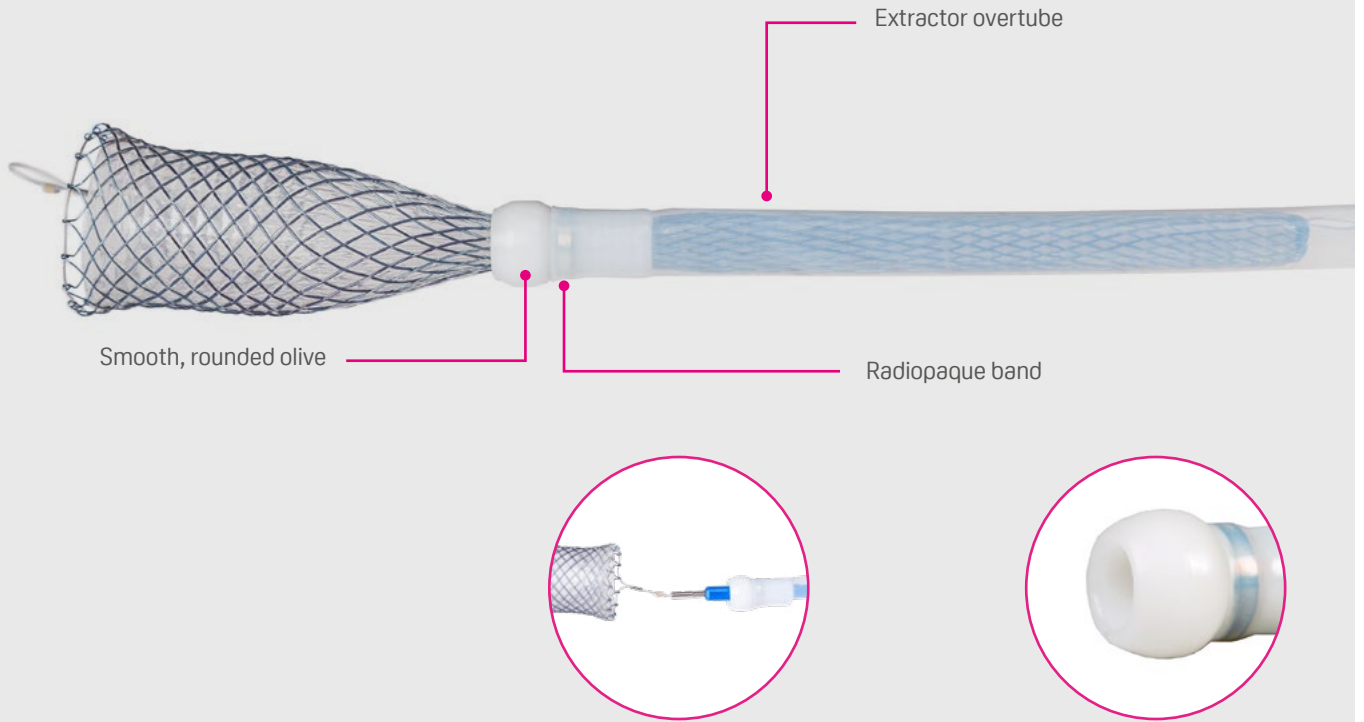

Easy and secure retrieval thread capture using Bowden hook control



Suitable for use with Danis Stent, Danis Seal and HV+ Ella Stents



## Kit contents:



## Danis Extractor - removal instructions

1. Scope the patient and observe the proximal end & retrieval thread on the stent.
2. Pass the inner extractor through working channel of scope until observed
3. Advance & capture the retrieval thread with the hook, using the Bowden hook control....

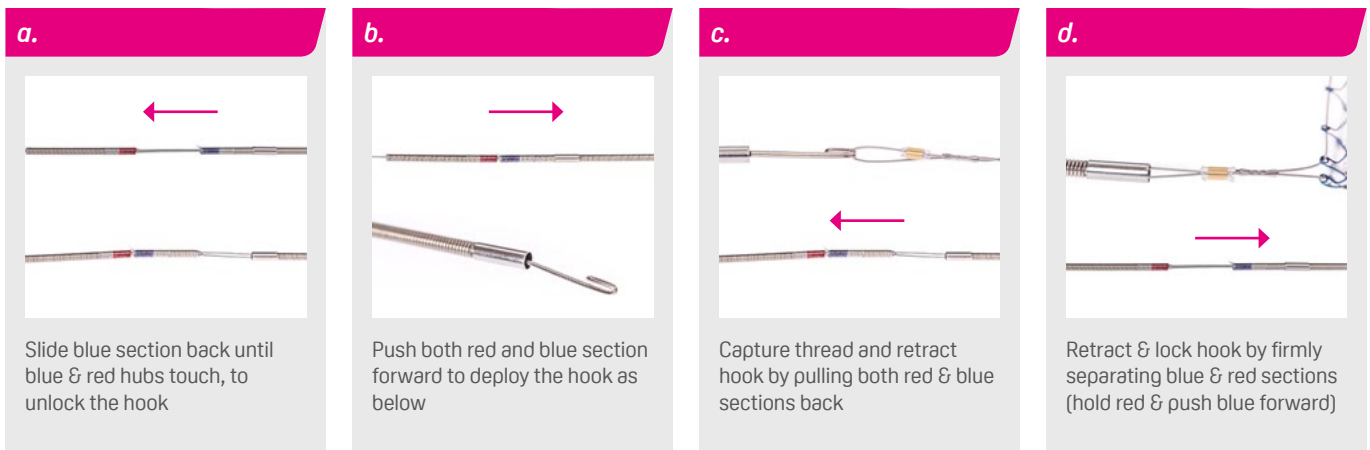

4. Remove scope , being careful not to apply any proximal movement to the stent.
5. Advance the outer sheath over the inner wire under fluoroscopic guidance until the radiopaque band is adjacent to the proximal end of the stent.
6. Hold the outer sheath still, while applying proximal traction to the inner wire, until the stent begins to 'purse'.
7. Once suitably 'purse'd' advance the outer sheath over the stent to provide atraumatic capture.

## Ordering Information

Product	Product Code	Nominal Diameter (mm)	Nominal Length
ELLA Extractor System	015-01-28-1000	9.4	100cm

Manufactured by



Distributed by:

UK Medical  
Albreda House  
Lydgate Lane  
Sheffield, S10 5FH

T: +44 (0) 114 268 8880  
F: +44 (0) 114 268 8881  
sales@ukmedical.com  
www.ukmedical.com

 @UK\_Medical

 **UKMEDICAL**<sup>®</sup>  
It's Interventional.