

# It's Epi-Guard

## Steps for use

These instructions are to be used as a reference guide only. Please refer to the full instructions for use prior to using this product.

## Fixing Instructions

### Step 1.

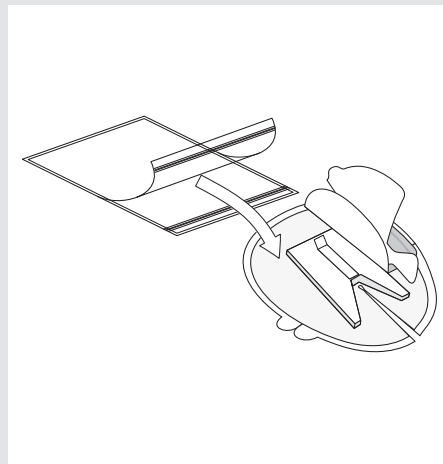

**Note:** Must be applied to a clean and dry skin surface.  
Take the Epi-Guard out of the pouch.

### Step 2.

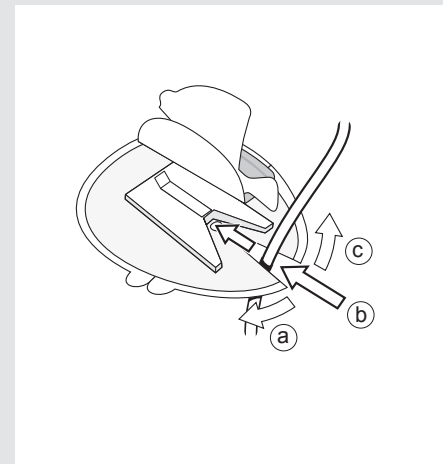

Open front slit for catheter insertion (a). Place Epi-Guard so catheter is positioned almost at bottom of slit (b).

### Step 3.

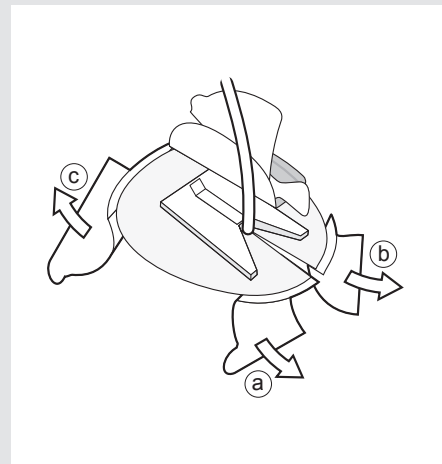

Remove two small pieces of siliconised paper (a & b) & affix to skin. Remove large siliconised paper (c) & press lightly to affix to skin.

### Step 4.

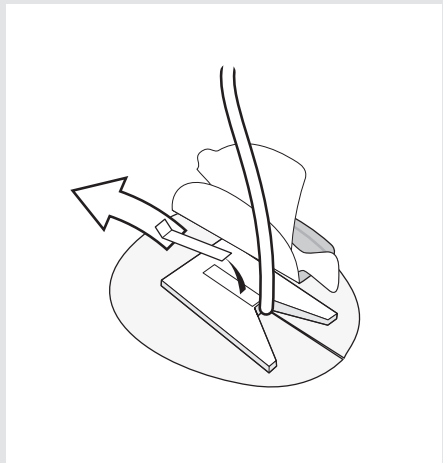

Remove siliconised paper on top of Epi-Guard.

### Step 5.

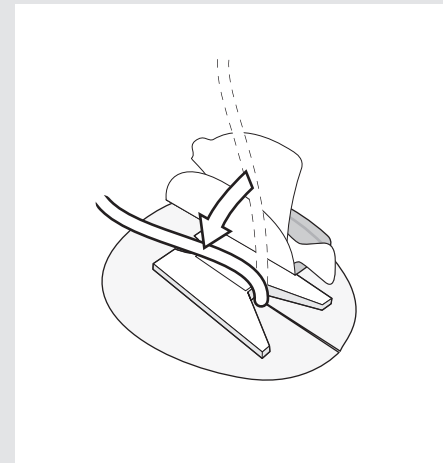

Place catheter on the exposed adhesive area.

### Step 6.



To apply the top cover pull tab of siliconised paper (a). Position top cover with the siliconised paper (b).

### Step 7.

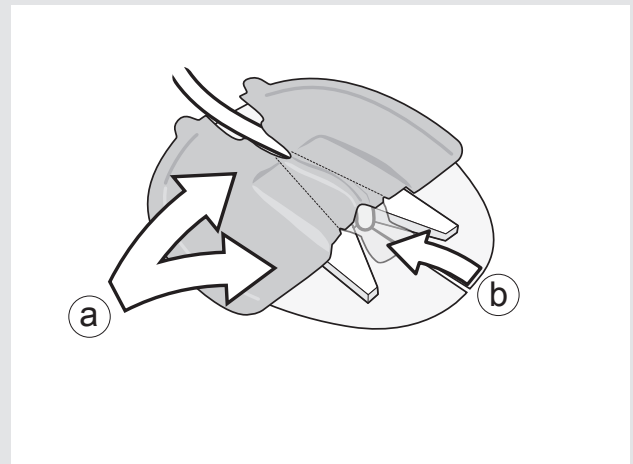

Press the top cover (a) to secure good adhesion to the top of the carrier & press the tongue-shaped hydrocolloid (b) around the puncture site.

### Step 8.

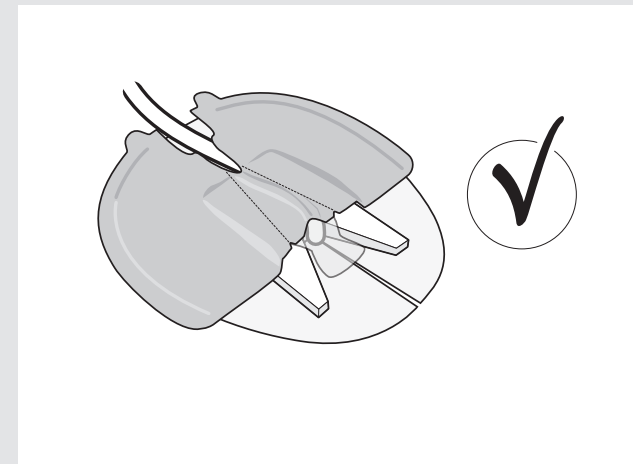

Epi-Guard application is finished.

## Removal Instructions

### Step 1 - 3.

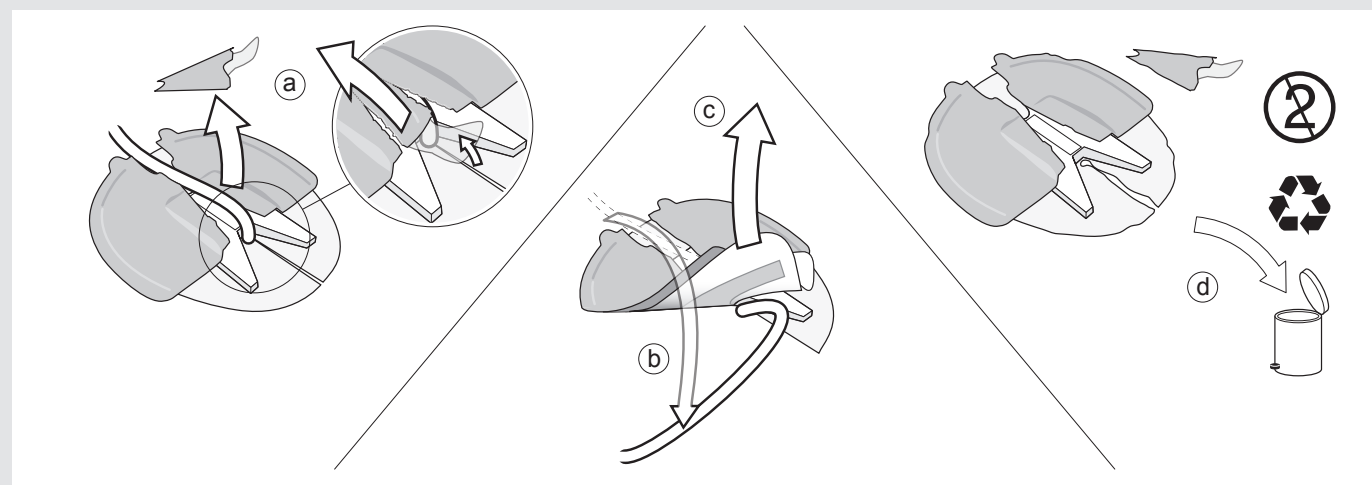

Peel off tongue-shaped hydrocolloid around puncture site (a). Peel off lid material along pre-cut lines (a). Lift catheter (b) away from adhesive top surface and cautiously remove Epi-Guard from skin surface (c). After use, dispose of product and packaging in accordance with hospital, administrative and/or local government policy (d).

### Additional information?

If you would like further assistance with using our Epi-Guard, or need advice on how to order, please call us on: 0114 268 8880.